

O-RINGS

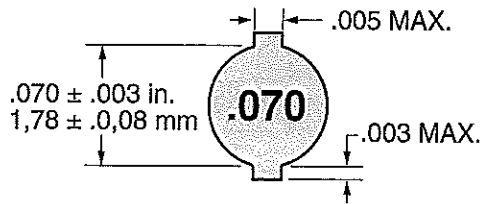

O-RING CROSS SECTION:
 .070 in. (1,78 mm)—1/16" nominal



SIZE AS568A	Internal Diameter in Inches		Internal Diameter in Millimeters		Nominal Size in Inches	
	I.D.	Tol.±	I.D.	Tol.±	I.D.	Tol. ±
*001	0.029	.004	0,735	0,10	1/32	3/32
*002	0.042	.004	1,07	0,10	3/64	9/64
*003	0.056	.004	1,42	0,10	1/16	3/16
004	0.070	.005	1,78	0,13	5/64	13/16
005	0.101	.005	2,57	0,13	3/32	7/32
006	0.114	.005	2,90	0,13	1/8	1/4
007	0.145	.005	3,69	0,13	5/32	9/32
008	0.176	.005	4,47	0,13	3/16	5/16
009	0.208	.005	5,28	0,13	7/32	11/32
010	0.239	.005	6,07	0,13	1/4	3/8
011	0.301	.005	7,66	0,13	5/16	7/16
012	0.364	.005	9,25	0,13	3/8	1/2
013	0.426	.005	10,82	0,13	7/16	9/16
014	0.489	.005	12,42	0,13	1/2	5/8
015	0.551	.007	14,00	0,18	9/16	11/16
016	0.614	.009	15,60	0,23	5/8	3/4
017	0.676	.009	17,16	0,23	11/16	13/16
018	0.739	.009	18,77	0,23	3/4	7/8
019	0.801	.009	20,35	0,23	13/16	15/16
020	0.864	.009	21,95	0,23	7/8	1
021	0.926	.009	23,52	0,23	15/16	1-1/16
022	0.989	.010	25,12	0,25	1	1-1/8
023	1.051	.010	26,70	0,25	1-1/16	1-3/16
024	1.114	.010	28,30	0,25	1-1/8	1-1/4
025	1.176	.011	29,87	0,28	1-3/16	1-5/16

SIZE AS568A	Internal Diameter in Inches		Internal Diameter in Millimeters		Nominal Size in Inches	
	I.D.	Tol.±	I.D.	Tol.±	I.D.	Tol. ±
026	1.239	.011	31,47	0,28	1-1/4	1-3/8
027	1.301	.011	33,05	0,28	1-5/16	1-7/16
028	1.364	.013	34,65	0,33	1-3/8	1-1/2
029	1.489	.013	37,82	0,33	1-1/2	1-5/8
030	1.614	.013	41,00	0,33	1-5/8	1-3/4
031	1.739	.015	44,17	0,38	1-3/4	1-7/8
032	1.864	.015	47,37	0,38	1-7/8	2
033	1.989	.018	50,52	0,46	2	2-1/8
034	2.114	.018	53,67	0,46	2-1/8	2-1/4
035	2.239	.018	56,87	0,46	2-1/4	2-3/8
036	2.364	.018	60,04	0,46	2-3/8	2-1/2
037	2.489	.018	63,22	0,46	2-1/2	2-5/8
038	2.614	.020	66,40	0,51	2-5/8	2-3/4
039	2.739	.020	69,57	0,51	2-3/4	2-7/8
040	2.864	.020	72,76	0,51	2-7/8	3
041	2.989	.024	75,94	0,61	3	3-1/8
042	3.239	.024	82,28	0,61	3-1/4	3-3/8
043	3.489	.024	88,64	0,61	3-1/2	3-5/8
044	3.739	.027	95,00	0,69	3-3/4	3-7/8
045	3.989	.027	101,34	0,69	4	4-1/8
046	4.239	.030	107,70	0,76	4-1/4	4-3/8
047	4.489	.030	114,00	0,76	4-1/2	4-5/8
048	4.739	.030	120,40	0,76	4-3/4	4-7/8
049	4.989	.037	126,76	0,94	5	5-1/8
050	5.239	.037	133,10	0,94	5-1/4	5-3/8

* SIZE 001	C/S .040 ± .003
* SIZE 002	C/S .050 ± .003
* SIZE 003	C/S .060 ± .003



O-RINGS

O-RING CROSS SECTION:

.103 in. (2,62 mm)—3/32" nominal

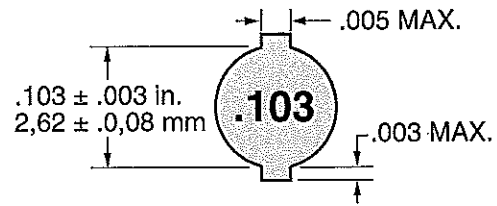

SIZE AS568A	Internal Diameter in Inches		Internal Diameter in Millimeters		Nominal Size in Inches	
	I.D.	Tol.±	I.D.	Tol.±	I.D.	Tol. ±
102	0.049	.005	1,24	0,13	1/16	1/4
103	0.081	.005	2,06	0,13	3/32	9/32
104	0.112	.005	2,84	0,13	1/8	5/16
105	0.143	.005	3,63	0,13	5/32	11/32
106	0.174	.005	4,42	0,13	3/16	3/8
107	0.206	.005	5,23	0,13	7/32	13/32
108	0.237	.005	6,02	0,13	1/4	7/16
109	0.299	.005	7,60	0,13	5/16	1/2
110	0.362	.005	9,19	0,13	3/8	9/16
111	0.424	.005	10,78	0,13	7/16	5/8
112	0.487	.005	12,37	0,13	1/2	11/16
113	0.549	.007	13,95	0,18	9/16	3/4
114	0.612	.009	15,54	0,23	5/8	13/16
115	0.674	.009	17,13	0,23	11/16	7/8
116	0.737	.009	18,72	0,23	3/4	15/16
117	0.799	.010	20,29	0,25	13/16	1
118	0.862	.010	21,90	0,25	7/8	1-1/16
119	0.924	.010	23,47	0,25	15/16	1-1/8
120	0.987	.010	25,07	0,25	1	1-3/16
121	1.049	.010	26,65	0,25	1-1/16	1-1/4
122	1.112	.010	28,25	0,25	1-1/8	1-5/16
123	1.174	.012	29,83	0,30	1-3/16	1-3/8
124	1.237	.012	31,42	0,30	1-1/4	1-7/16
125	1.299	.012	33,00	0,30	1-5/16	1-1/2
126	1.362	.012	34,60	0,30	1-3/8	1-9/16
127	1.424	.012	36,17	0,30	1-7/16	1-5/8
128	1.487	.012	37,77	0,30	1-1/2	1-11/16
129	1.549	.015	39,35	0,38	1-9/16	1-3/4
130	1.612	.015	40,95	0,38	1-5/8	1-13/16
131	1.674	.015	42,52	0,38	1-11/16	1-7/8
132	1.737	.015	44,12	0,38	1-3/4	1-15/16
133	1.799	.015	45,70	0,38	1-13/16	2
134	1.862	.015	47,30	0,38	1-7/8	2-1/16
135	1.925	.017	48,90	0,43	1-15/16	2-1/8
136	1.987	.017	50,47	0,43	2	2-3/16
137	2.050	.017	52,07	0,43	2-1/16	2-1/4
138	2.112	.017	53,65	0,43	2-1/8	2-5/16
139	2.175	.017	55,25	0,43	2-3/16	2-3/8
140	2.237	.017	56,82	0,43	2-1/4	2-7/16

SIZE AS568A	Internal Diameter in Inches		Internal Diameter in Millimeters		Nominal Size in Inches	
	I.D.	Tol.±	I.D.	Tol.±	I.D.	Tol. ±
141	2.300	.020	58,42	0,51	2-5/16	2-1/4
142	2.362	.020	60,00	0,51	2-3/8	2-9/16
143	2.425	.020	61,60	0,51	2-7/16	2-5/8
144	2.487	.020	63,17	0,51	2-1/2	2-11/16
145	2.550	.020	64,77	0,51	2-9/16	2-3/4
146	2.612	.020	66,35	0,51	2-5/8	2-13/16
147	2.675	.022	67,95	0,56	2-11/16	2-7/8
148	2.737	.022	69,52	0,56	2-3/4	2-15/16
149	2.800	.022	71,12	0,56	2-13/16	3
150	2.862	.022	72,70	0,56	2-7/8	3-1/16
151	2.987	.024	75,88	0,61	3	3-3/16
152	3.237	.024	82,22	0,61	3-1/4	3-7/16
153	3.487	.024	88,58	0,61	3-1/2	3-11/16
154	3.737	.028	94,93	0,71	3-3/4	3-15/16
155	3.987	.028	101,28	0,71	4	4-3/16
156	4.237	.030	107,63	0,76	4-1/4	4-7/16
157	4.487	.030	113,98	0,76	4-1/2	4-11/16
158	4.737	.030	120,33	0,76	4-3/4	4-15/16
159	4.987	.035	126,67	0,89	5	5-3/16
160	5.237	.035	133,00	0,89	5-1/4	5-7/16
161	5.487	.035	139,38	0,89	5-1/2	5-11/16
162	5.737	.035	145,73	0,89	5-3/4	5-15/16
163	5.987	.035	152,07	0,89	6	6-3/16
164	6.237	.040	158,43	1,02	6-1/4	6-7/16
165	6.487	.040	164,78	1,02	6-1/2	6-11/16
166	6.737	.040	171,13	1,02	6-3/4	6-15/16
167	6.987	.040	177,48	1,02	7	7-3/16
168	7.237	.045	183,83	1,14	7-1/4	7-7/16
169	7.487	.045	190,18	1,14	7-1/2	7-11/16
170	7.737	.045	196,53	1,14	7-3/4	7-15/16
171	7.987	.045	202,88	1,14	8	8-3/16
172	8.237	.050	209,23	1,27	8-1/4	8-7/16
173	8.487	.050	215,58	1,27	8-1/2	8-11/16
174	8.737	.050	221,93	1,27	8-3/4	8-15/16
175	8.987	.050	228,28	1,27	9	9-3/16
176	9.237	.055	234,63	1,40	9-1/4	9-7/16
177	9.487	.055	240,98	1,40	9-1/2	9-11/16
178	9.737	.055	247,33	1,40	9-3/4	9-15/16

O-RINGS



O-RING CROSS SECTION: .139 in. (3,53 mm)—1/18" nominal

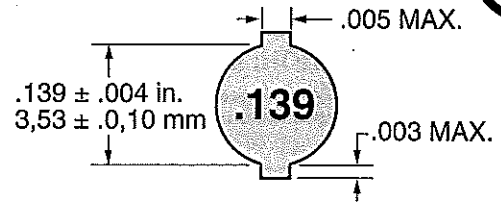

SIZE AS568A	Internal Diameter in Inches		Internal Diameter in Millimeters		Nominal Size in Inches	
	I.D.	Tol.±	I.D.	Tol.±	I.D.	Tol. ±
201	0.171	.006	4,34	0,15	3/16	7/16
202	0.234	.007	5,94	0,18	1/4	1/2
203	0.296	.007	7,52	0,18	5/16	9/16
204	0.359	.007	9,12	0,18	3/8	5/8
205	0.421	.007	10,69	0,18	7/16	11/16
206	0.484	.007	12,29	0,18	1/2	3/4
207	0.546	.007	13,87	0,18	9/16	13/16
208	0.609	.009	15,47	0,23	5/8	7/8
209	0.671	.009	17,04	0,23	11/16	15/16
210	0.734	.010	18,64	0,25	3/4	1
211	0.796	.010	20,22	0,25	13/16	1-1/16
212	0.859	.010	21,82	0,25	7/8	1-1/8
213	0.921	.010	23,40	0,25	15/16	1-3/16
214	0.984	.010	25,00	0,25	1	1-1/4
215	1.046	.010	26,57	0,25	1-1/16	1-5/16
216	1.109	.012	28,17	0,30	1-1/8	1-3/8
217	1.171	.012	29,75	0,30	1-3/16	1-7/16
218	1.234	.012	31,34	0,30	1-1/4	1-1/2
219	1.296	.012	32,93	0,30	1-5/16	1-9/16
220	1.359	.012	34,52	0,30	1-3/8	1-5/8
221	1.421	.012	36,10	0,30	1-7/16	1-11/16
222	1.484	.015	37,70	0,38	1-1/2	1-3/4
223	1.609	.015	40,87	0,38	1-5/8	1-7/8
224	1.734	.015	44,05	0,38	1-3/4	2
225	1.859	.018	47,23	0,46	1-7/8	2-1/8
226	1.984	.018	50,40	0,46	2	2-1/4
227	2.109	.018	53,57	0,46	2-1/8	2-3/8
228	2.234	.020	56,75	0,51	2-1/4	2-1/2
229	2.359	.020	59,92	0,51	2-3/8	2-5/8
230	2.484	.020	63,10	0,51	2-1/2	2-3/4
231	2.609	.020	66,27	0,51	2-5/8	2-7/8
232	2.734	.024	69,44	0,61	2-3/4	3
233	2.859	.024	72,62	0,61	2-7/8	3-1/8
234	2.984	.024	75,80	0,61	3	3-1/4
235	3.109	.024	78,97	0,61	3-1/8	3-3/8
236	3.234	.024	82,14	0,61	3-1/4	3-1/2
237	3.359	.024	85,32	0,61	3-3/8	3-5/8
238	3.484	.024	88,50	0,61	3-1/2	3-3/4
239	3.609	.028	91,67	0,71	3-5/8	3-7/8
240	3.734	.028	94,84	0,71	3-3/4	4
241	3.859	.028	98,02	0,71	3-7/8	4-1/8
242	3.984	.028	101,20	0,71	4	4-1/4
243	4.109	.028	104,37	0,71	4-1/8	4-3/8
244	4.234	.030	107,54	0,76	4-1/4	4-1/2
245	4.359	.030	110,72	0,76	4-3/8	4-5/8

SIZE AS568A	Internal Diameter in Inches		Internal Diameter in Millimeters		Nominal Size in Inches	
	I.D.	Tol.±	I.D.	Tol.±	I.D.	Tol. ±
246	4.484	.030	113,90	0,76	4-1/2	4-3/4
247	4.609	.030	117,07	0,76	4-5/8	4-7/8
248	4.734	.030	120,24	0,76	4-3/4	5
249	4.859	.035	123,42	0,89	4-7/8	5-1/8
250	4.984	.035	126,60	0,89	5	5-1/4
251	5.109	.035	129,77	0,89	5-1/8	5-3/8
252	5.234	.035	132,94	0,89	5-1/4	5-1/2
253	5.359	.035	136,12	0,89	5-3/8	5-5/8
254	5.484	.035	139,30	0,89	5-1/2	5-3/4
255	5.609	.035	142,47	0,89	5-5/8	5-7/8
256	5.734	.035	145,65	0,89	5-3/4	6
257	5.859	.035	148,82	0,89	5-7/8	6-1/8
258	5.984	.035	152,00	0,89	6	6-1/4
259	6.234	.040	158,35	1,02	6-1/4	6-1/2
260	6.484	.040	164,70	1,02	6-1/2	6-3/4
261	6.734	.040	171,05	1,02	6-3/4	7
262	6.984	.040	177,40	1,02	7	7-1/4
263	7.234	.045	183,75	1,14	7-1/4	7-1/2
264	7.484	.045	190,10	1,14	7-1/2	7-3/4
265	7.734	.045	196,45	1,14	7-3/4	8
266	7.984	.045	202,80	1,14	8	8-1/4
267	8.234	.050	209,15	1,27	8-1/4	8-1/2
268	8.484	.050	215,50	1,27	8-1/2	8-3/4
269	8.734	.050	221,85	1,27	8-3/4	9
270	8.984	.050	228,20	1,27	9	9-1/4
271	9.234	.055	234,55	1,40	9-1/4	9-1/2
272	9.484	.055	240,90	1,40	9-1/2	9-3/4
273	9.734	.055	247,25	1,40	9-3/4	10
274	9.984	.055	253,60	1,40	10	10-1/4
275	10.484	.055	266,30	1,40	10-1/2	10-3/4
276	10.984	.065	279,00	1,65	11	11-1/4
277	11.484	.065	291,70	1,65	11-1/2	11-3/4
278	11.984	.065	304,40	1,65	12	12-1/2
279	12.984	.065	329,80	1,65	13	13-1/4
280	13.984	.065	355,20	1,65	14	14-1/4
281	14.984	.065	380,60	1,65	15	15-1/4
282	15.955	.075	405,26	1,91	16	16-1/4
283	16.955	.080	430,66	2,03	17	17-1/4
284	17.955	.085	456,06	2,16	18	18-1/4



O-RINGS

O-RING CROSS SECTION: .210 in. (5,34 mm)—3/16" nominal

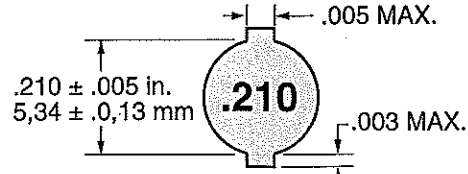

SIZE AS568A	Internal Diameter In Inches		Internal Diameter In Millimeters		7/16 Nominal Size in Inches	
	I.D.	Tol.±	I.D.	Tol.±	1/2 I.D.	Tol. ±
309	0.412	.005	10,46	0,13	7/16	13/16
310	0.475	.005	12,07	0,13	1/2	7/8
311	0.537	.007	13,64	0,18	9/16	15/16
312	0.600	.009	15,24	0,23	5/8	1
313	0.662	.009	16,81	0,23	11/16	1-1/16
314	0.725	.009	18,42	0,23	3/4	1-1/8
315	0.787	.009	19,99	0,23	13/16	1-3/16
316	0.850	.009	21,59	0,23	7/8	1-1/4
317	0.912	.009	23,16	0,23	15/16	1-5/16
318	0.975	.010	24,77	0,25	1	1-3/8
319	1.037	.010	26,34	0,25	1-1/16	1-7/16
320	1.100	.010	27,94	0,25	1-1/8	1-1/2
321	1.162	.011	29,51	0,28	1-3/16	1-9/16
322	1.225	.011	31,12	0,28	1-1/4	1-5/8
323	1.287	.011	32,69	0,28	1-5/16	1-11/16
324	1.350	.011	34,29	0,28	1-3/8	1-3/4
325	1.475	.015	37,47	0,38	1-1/2	1-7/8
326	1.600	.015	40,65	0,38	1-5/8	2
327	1.725	.015	43,82	0,38	1-3/4	2-1/8
328	1.850	.015	47,00	0,38	1-7/8	2-1/4
329	1.975	.018	50,16	0,46	2	2-3/8
330	2.100	.018	53,34	0,46	2-1/8	2-1/2
331	2.225	.018	56,52	0,46	2-1/4	2-5/8
332	2.350	.018	59,70	0,46	2-3/8	2-3/4
333	2.475	.020	62,87	0,51	2-1/2	2-7/8
334	2.600	.020	66,04	0,51	2-5/8	3
335	2.725	.020	69,22	0,51	2-3/4	3-1/8
336	2.850	.020	72,40	0,51	2-7/8	3-1/4
337	2.975	.024	75,57	0,61	3	3-3/8
338	3.100	.024	78,74	0,61	3-1/8	3-1/2
339	3.225	.024	81,92	0,61	3-1/4	3-5/8
340	3.350	.024	85,10	0,61	3-3/8	3-3/4
341	3.475	.024	88,27	0,61	3-1/2	3-7/8
342	3.600	.028	91,44	0,71	3-5/8	4
343	3.725	.028	94,62	0,71	3-3/4	4-1/8
344	3.850	.028	97,80	0,71	3-7/8	4-1/4
345	3.975	.028	100,97	0,71	4	4-3/8
346	4.100	.028	104,14	0,71	4-1/8	4-1/2
347	4.225	.030	107,32	0,76	4-1/4	4-5/8
348	4.350	.030	110,50	0,76	4-3/8	4-3/4
349	4.475	.030	113,67	0,76	4-1/2	4-7/8
350	4.600	.030	116,84	0,76	4-5/8	5
351	4.725	.030	120,02	0,76	4-3/4	5-1/8
352	4.850	.030	123,20	0,76	4-7/8	5-1/4
353	4.975	.037	126,37	0,94	5	5-3/8

SIZE AS568A	Internal Diameter in Inches		Internal Diameter in Millimeters		Nominal Size in Inches	
	I.D.	Tol.±	I.D.	Tol.±	I.D.	Tol. ±
354	5.100	.037	129,54	0,94	5-1/8	5-1/2
355	5.225	.037	132,72	0,94	5-1/4	5-5/8
356	5.350	.037	135,90	0,94	5-3/8	5-3/4
357	5.475	.037	139,07	0,94	5-1/2	5-7/8
358	5.600	.037	142,24	0,94	5-5/8	6
359	5.725	.037	145,42	0,94	5-3/4	6-1/8
360	5.850	.037	148,60	0,94	5-7/8	6-1/4
361	5.975	.037	151,77	0,94	6	6-3/8
362	6.225	.040	158,12	1,02	6-1/4	6-5/8
363	6.475	.040	164,47	1,02	6-1/2	6-7/8
364	6.725	.040	170,82	1,02	6-3/4	7-1/8
365	6.975	.040	177,17	1,02	7	7-3/8
366	7.225	.045	183,52	1,14	7-1/4	7-5/8
367	7.475	.045	189,87	1,14	7-1/2	7-7/8
368	7.725	.045	196,22	1,14	7-3/4	8-1/8
369	7.975	.045	202,57	1,14	8	8-3/8
370	8.225	.050	208,92	1,27	8-1/4	8-5/8
371	8.475	.050	215,27	1,27	8-1/2	8-7/8
372	8.725	.050	221,62	1,27	8-3/4	9-1/8
373	8.975	.050	227,97	1,27	9	9-3/8
374	9.225	.055	234,32	1,40	9-1/4	9-5/8
375	9.475	.055	240,67	1,40	9-1/2	9-7/8
376	9.725	.055	247,02	1,40	9-3/4	10-1/8
377	9.975	.055	253,37	1,40	10	10-3/8
378	10.475	.060	266,07	1,52	10-1/2	10-7/8
379	10.975	.060	278,77	1,52	11	11-3/8
380	11.475	.065	291,47	1,65	11-1/2	11-7/8
381	11.975	.065	304,17	1,65	12	12-3/8
382	12.975	.065	329,57	1,65	13	13-3/8
383	13.975	.070	354,97	1,78	14	14-3/8
384	14.975	.070	380,37	1,78	15	15-3/8
385	15.955	.075	405,26	1,91	16	16-3/8
386	16.955	.080	430,66	2,03	17	17-3/8
387	17.955	.085	456,06	2,16	18	18-3/8
388	18.955	.090	481,46	2,29	19	19-3/8
389	19.955	.095	506,86	2,41	20	20-3/8
390	20.955	.095	532,26	2,41	21	21-3/8
391	21.955	.100	557,66	2,54	22	22-3/8
392	22.940	.105	582,68	2,67	23	23-3/8
393	23.940	.110	608,08	2,79	24	24-3/8
394	24.940	.115	633,48	2,92	25	25-3/8
395	25.940	.120	658,88	3,05	26	26-3/8

O-RINGS

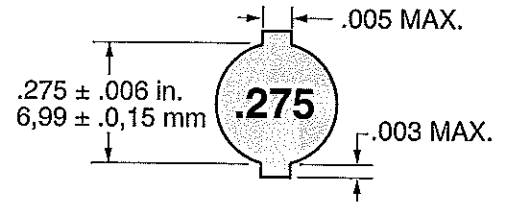

O-RING CROSS SECTION:
 .070 in. (1,78 mm)—1/16" nominal

SIZE AS568A	Internal Diameter in Inches		Internal Diameter in Millimeters		Nominal Size in Inches	
	I.D.	Tol. ±	I.D.	Tol. ±	I.D.	Tol. ±
425	4.475	.033	113,67	0,84	4-1/2	5
426	4.600	.033	116,84	0,84	4-5/8	5-1/8
427	4.725	.033	120,02	0,84	4-3/4	5-1/4
428	4.850	.033	123,20	0,84	4-7/8	5-3/8
429	4.975	.037	126,37	0,94	5	5-1/2
430	5.100	.037	129,54	0,94	5-1/8	5-5/8
431	5.225	.037	132,72	0,94	5-1/4	5-3/4
432	5.350	.037	135,90	0,94	5-3/8	5-7/8
433	5.475	.037	139,07	0,94	5-1/2	6
434	5.600	.037	142,24	0,94	5-5/8	6-1/8
435	5.725	.037	145,42	0,94	5-3/4	6-1/4
436	5.850	.037	148,60	0,94	5-7/8	6-3/8
437	5.975	.037	151,77	0,94	6	6-1/2
438	6.225	.037	158,12	0,94	6-1/4	6-3/4
439	6.475	.040	164,47	1,02	6-1/2	7
440	6.725	.040	170,82	1,02	6-3/4	7-1/4
441	6.975	.040	177,17	1,02	7	7-1/2
442	7.225	.045	183,52	1,14	7-1/4	7-3/4
443	7.475	.045	189,87	1,14	7-1/2	8
444	7.725	.045	196,22	1,14	7-3/4	8-1/4
445	7.975	.045	202,57	1,14	8	8-1/2
446	8.475	.045	215,27	1,14	8-1/2	9
447	8.975	.055	227,97	1,40	9	9-1/2
448	9.475	.055	240,67	1,40	9-1/2	10
449	9.975	.055	253,57	1,40	10	10-1/2
450	10.475	.060	266,07	1,52	10-1/2	11

SIZE AS568A	Internal Diameter in Inches		Internal Diameter in Millimeters		Nominal Size in Inches	
	I.D.	Tol. ±	I.D.	Tol. ±	I.D.	Tol. ±
451	10.975	.060	278,77	1,52	11	11-1/2
452	11.475	.060	291,47	1,52	11-1/2	12
453	11.975	.060	304,17	1,52	12	12-1/2
454	12.475	.060	316,87	1,52	12-1/2	13
455	12.975	.060	329,57	1,52	13	13-1/2
456	13.475	.070	342,27	1,78	13-1/2	14
457	13.975	.070	354,97	1,78	14	14-1/2
458	14.475	.070	367,67	1,78	14-1/2	15
459	14.975	.070	380,37	1,78	15	15-1/2
460	15.475	.070	393,07	1,78	15-1/2	16
461	15.955	.075	405,26	1,91	16	16-1/2
462	16.455	.075	417,96	1,91	16-1/2	17
463	16.955	.080	430,66	2,03	17	17-1/2
464	17.455	.085	443,36	2,16	17-1/2	18
465	17.955	.085	456,06	2,16	18	18-1/2
466	18.455	.085	468,76	2,16	18-1/2	19
467	18.955	.090	481,46	2,29	19	19-1/2
468	19.455	.090	494,16	2,29	19-1/2	20
469	19.955	.095	506,86	2,41	20	20-1/2
470	20.955	.095	532,26	2,41	21	21-1/2
471	21.955	.100	557,66	2,54	22	22-1/2
472	22.940	.105	582,68	2,67	23	23-1/2
473	23.940	.110	608,08	2,79	24	24-1/2
474	24.940	.115	633,48	2,92	25	25-1/2
475	25.940	.120	658,88	3,05	26	26-1/2



O-RINGS

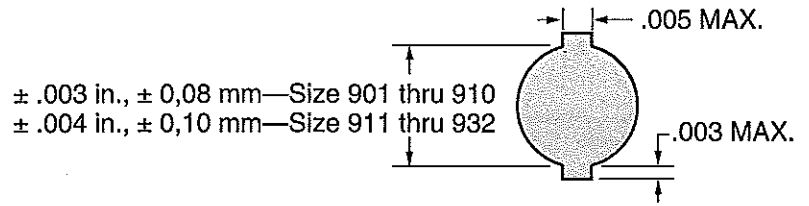

O-RING FOR TUBE FITTING BOSSES

SIZE AS568A	Tube Size		Volume of Ring Cu. In.	INSIDE DIAMETER (Inches)				INSIDE DIAMETER (Millimeters)				Size AS568A
	Dash No.	O.D. In.		I.D.	Tol.	C/S	±	I.D.	Tol.	C/S	±	
901		3/32	.0019	.185	.005	.056	.003	4,70	0,13	1,42	0,08	901
902	2	1/8	.0031	.239	.005	.064	.003	6,07	0,13	1,63	0,08	902
903	3	3/16	.0037	.301	.005	.064	.003	7,65	0,13	1,63	0,08	903
904	4	1/4	.0054	.351	.005	.072	.003	8,90	0,13	1,83	0,08	904
905	5	5/16	.0062	.414	.007	.072	.003	10,51	0,13	1,83	0,08	905
906	6	3/8	.0082	.468	.007	.078	.003	11,90	0,13	1,98	0,08	906
907		7/16	.0102	.530	.007	.082	.003	13,46	0,18	2,08	0,08	907
908	8	1/2	.0137	.644	.009	.087	.003	16,36	0,23	2,20	0,08	908
909		9/16	.0186	.706	.009	.097	.003	17,93	0,23	2,46	0,08	909
910	10	5/8	.0198	.755	.009	.097	.003	19,18	0,23	2,46	0,08	910
911		11/16	.0326	.863	.009	.116	.004	21,92	0,23	2,95	0,10	911
912	12	3/4	.0345	.924	.009	.116	.004	23,47	0,23	2,95	0,10	912
913		13/16	.0366	.986	.010	.116	.004	25,04	0,25	2,95	0,10	913
914		7/8	.0386	1.047	.010	.116	.004	26,62	0,25	2,95	0,10	914
916	16	1	.0427	1.171	.010	.116	.004	29,74	0,25	2,95	0,10	916
918		1-1/8	.0489	1.355	.012	.116	.004	34,42	0,30	2,95	0,10	918
920	20	1-1/4	.0547	1.475	.014	.118	.004	37,46	0,36	3,00	0,10	920
924	24	1-1/2	.0631	1.720	.014	.118	.004	43,70	0,36	3,00	0,10	924
928	28	1-3/4	.0759	2.090	.018	.118	.004	53,10	0,46	3,00	0,10	928
932	32	2	.0843	2.337	.018	.118	.004	59,36	0,46	3,00	0,10	932

The 900 series boss seals are designed to seal straight thread tube fittings when they are fastened into a boss. In this type of fitting the O-Ring is not located in a conventional rectangular groove. Rather, the seal is obtained when the gland components exert a diagonal squeeze through the O-Ring cross section.